



XmasbyQuiltmania



Jour 14 - *la Maison*

Appliqués : Point primitif

Broderies : Point lancé, point de couchure, point de sable

Day 14 - *the House*

Appliqués: Primitive stitch

Embroideries: Straight stitch, Couching stitch, Seed stitch



XmasbyQuiltmania

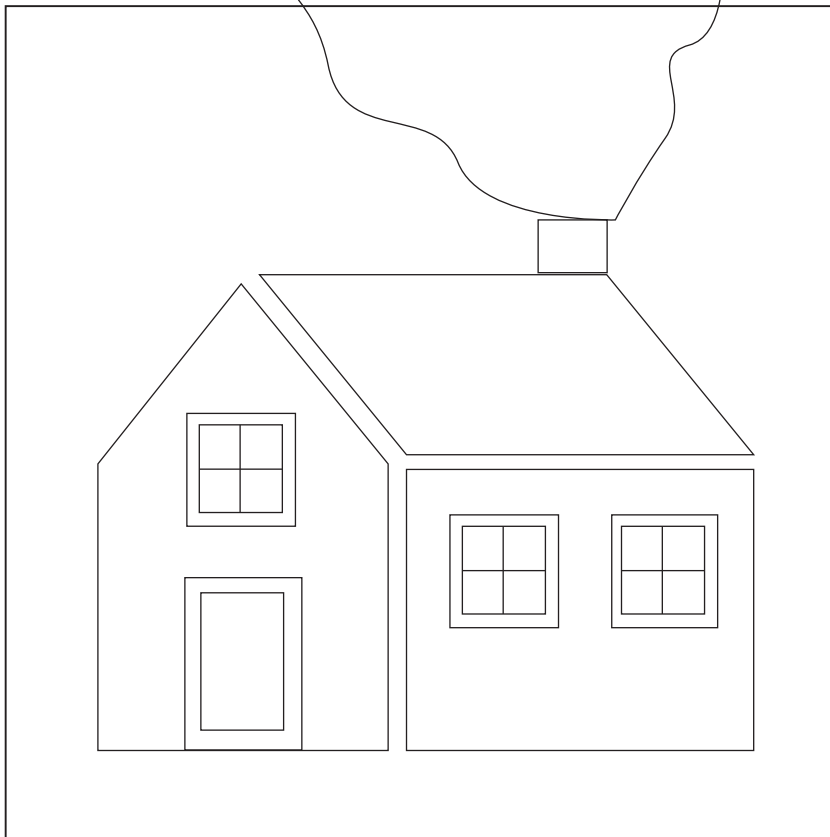

Gabarit à taille réelle Full size template